

# SubConn® Micro Low Profile 7 and 9 contacts

## Connector specifications

Voltage rating	300 V DC/AC rms
Current rating	5 A per contact (max 20 A per connector)
Insulation resistance	> 200 MΩ
Contact resistance	< 0.01 Ω
Wet matings	> 500
Temperature rating (water)	- 4 to 60°C, 25 to 140°F
Temperature rating (air)	- 40 to 60°C, - 40 to 140°F
Storage temperature rating	- 40 to 60°C, - 40 to 140°F
Qualified pressure tested	1,400 bar, 20,300 psi (mated) 800 bar, 11,600 psi (open face)
Depth rating PEEK	300 bar, 4,350 psi

## Material specifications

Connector body	Chloroprene rubber
Bulkhead body	Brass, stainless steel, titanium, anodised aluminium or PEEK
Contacts	Female sockets in gold plated brass UNS - C36000 Male contacts in gold plated beryllium copper
O-rings	Nitrile
Locking strap	Chloroprene rubber
Inline cable (2 ft, 60 cm)	20 AWG, 0.52 mm <sup>2</sup> synthetic rubber
Bulkhead leads (1 ft, 30 cm)	20 AWG, 0.52 mm <sup>2</sup> coloured PTFE
OM leads (3", 7 cm)	20 AWG, 0.52 mm <sup>2</sup> coloured PTFE

## Face view (male)

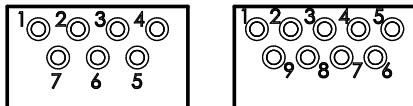

## Inline cable colour code

1 Black	4 Green	7 White/black	10 Orange/black**
2 White	5 Orange	8 Red/black*	
3 Red	6 Blue	9 Green/black	

\* Micro 7 contacts connector uses an 8 conductor cable (only 7 conductors are used)

\*\* Micro 9 contacts connector uses a 10 conductor cable (only 9 conductors are used)

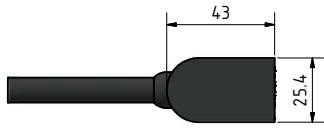

MCLPIL7F

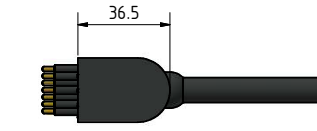

MCLPIL7M

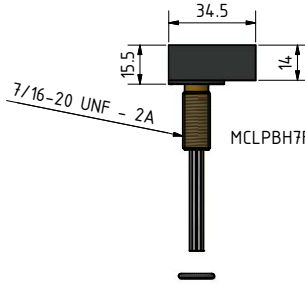
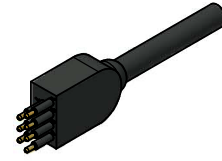

MCLPBH7F

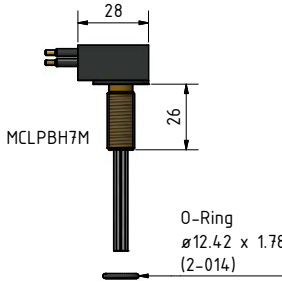

MCLPBH7M

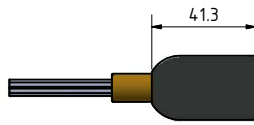
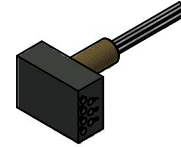

MCLPOM7F

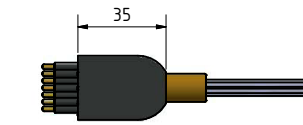

MCLPOM7M

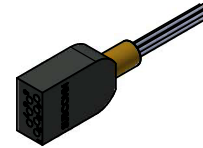

MCLPDC7F



MCLPDC7M

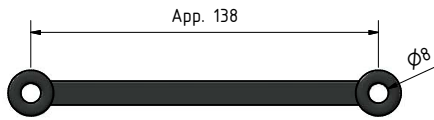
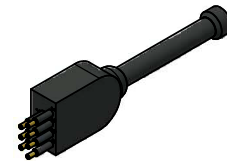

LPA Strap



**Drawing information**

Dimensions in mm (1 mm = 0.03937 inches)  
Threads in inches (1 inch = 25.4 mm)